

# KYLIE XTRA

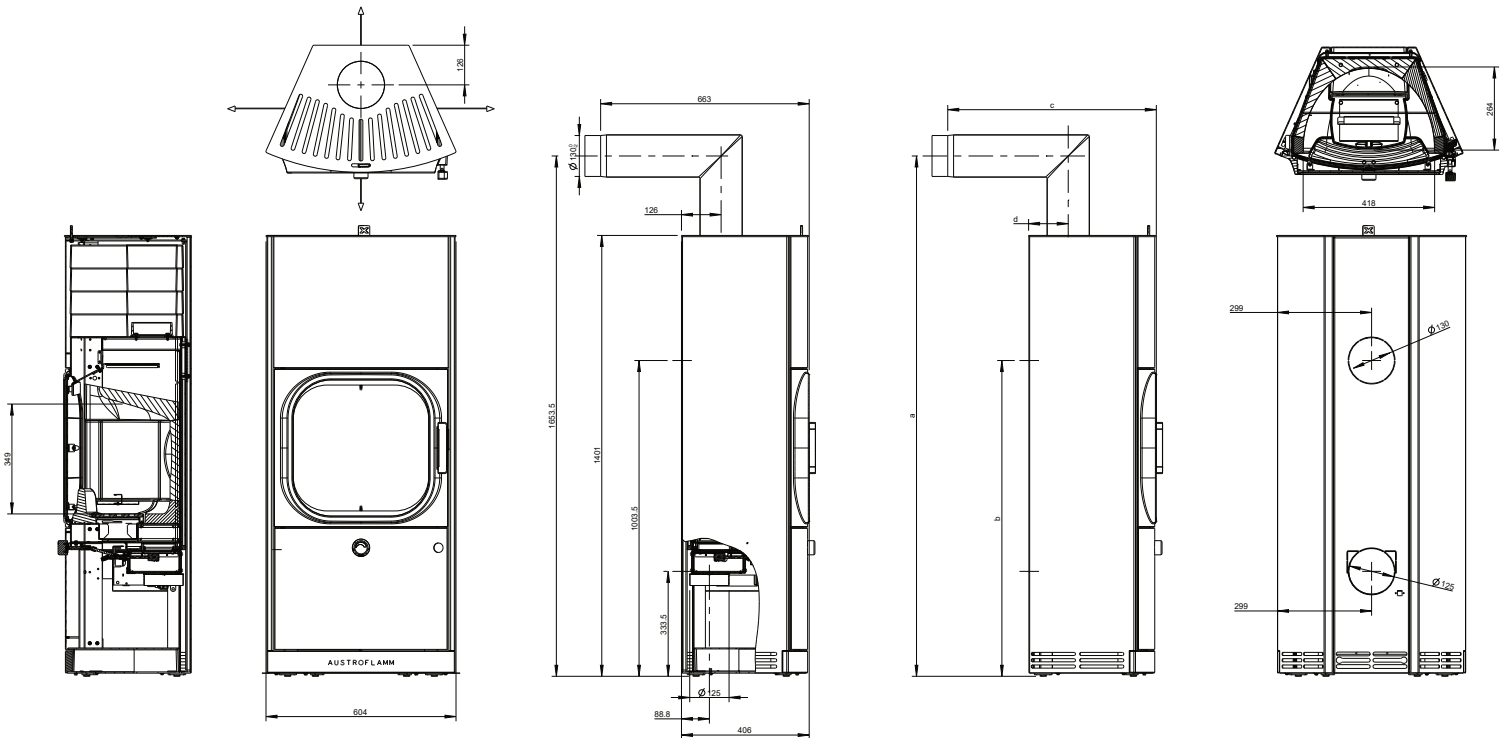

Dimensions and weight	
Height [mm]	1401
Width [mm]	604
Depth [mm]	406
Combustion chamber width [mm]	418
Combustion chamber height [mm]	349
Combustion chamber depth [mm]	264
Baking compartment width [mm]	-
Baking compartment height [mm]	-
Baking compartment depth [mm]	-
Warming drawer, width [mm]	-
Warming compartment height [mm]	-
Warming drawer, depth [mm]	-
Dimensions, a (with Austroflamm elbow piece) [mm]	1654
Dimensions, b (with Austroflamm elbow piece) [mm]	1004
Dimensions, c (with Austroflamm elbow piece) [mm]	663
Dimensions, d (with Austroflamm elbow piece) [mm]	126
Flue pipe outlet, diameter [mm]	130
Outside air connection diameter [Ø mm]	125
Weight, basic appliance [kg]	276
Weight Xtra [kg]	136
Weight, HMS[kg]	-
Total weight inc. steel case (STM)[kg]	276
Total weight inc. ceramic case (KGM) [kg]	-
Total weight inc. soapstone case (SPM)[kg]	-
a: Safetydistance to combustible materials, front [mm]	1200
b: Safetydistance to combustible materials, left [mm]	200
c: Safetydistance to combustible materials, rear [mm]	200
d: Safetydistance to combustible materials, right [mm]	200
Safetydistance to combustible materials, floor [mm]	0
Output	
Nominal heat efficiency [kW]	6.0
Minimum heat output [kW]	3.5
Maximum heat output [kW]	8.0
Minimum room heating capacity [m <sup>3</sup> ]	65
Maximum room heating capacity [m <sup>3</sup> ]	165
Energy efficiency class	A+
Data for the chimney sweep	
Exhaust gas mass flow [g/s]	4.67
Flue gas temperature [°C]	297
Minimum delivery pressure at nominal heat output [Pa]	12
at 0.8 times nominal heat output [Pa]	10
Equipment	
Xtra heat storage technology	Standard
Heat Memory System	-
External air connection / operation independent of ambient air	Yes
Ash removal	Ash box

- not available